

THE BURNING OF NOTRE DAME

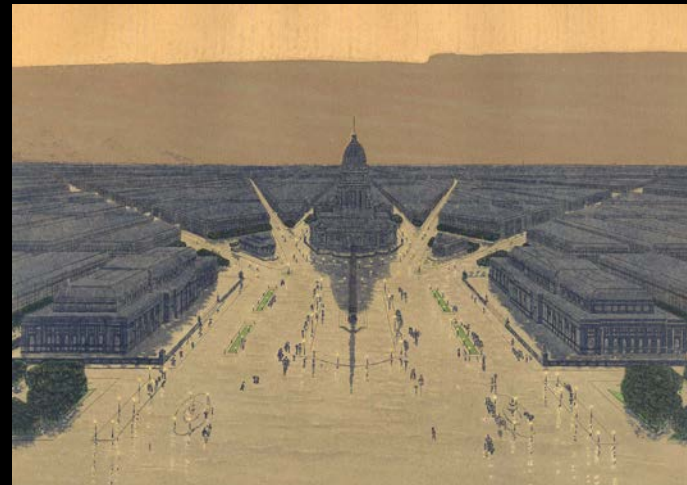

A SYMPOSIUM ON SACRED ARCHITECTURE
& THE THEOLOGY OF BEAUTY



Icons of Classical Humanist Urbanism (clockwise from bottom left):

- *The Ghent Altarpiece* (1432, detail), Paradise as New Eden and New Jerusalem
- 16th century depiction of Rome defined as her pilgrimage churches
- The World's Columbian Exposition, Chicago, (1893)
- Proposed City Hall and Plaza, *Plan of Chicago* (1909)

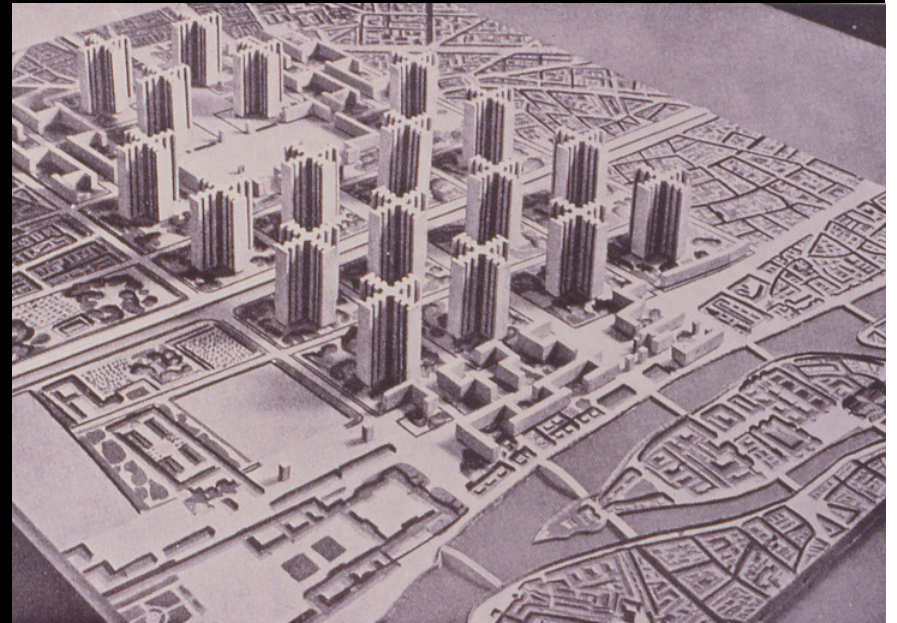

Clockwise from bottom left: Downtown Chicago circa 1900 / South Chicago Steel Mill / Le Corbusier's 1922 *Plan Voisin* for Paris (iconic modernist "solution" to the industrial city)

Rem Koolhaas

DELIRIOUS NEW YORK





World business.

In one place.

We live in **FINANCIAL TIMES**



Mergers and Acquisitions.

In-depth coverage.

We live in **FINANCIAL TIMES**

Top: Collage of iconic hyper-modern buildings as icon of the Global City
Bottom: ethos of the hyper-modern Global City (advertisements, courtesy of *Financial Times*)



Bess's First Law of Architecture and Urbanism:

“All architecture represents the power of its makers and their aspiration to (legitimate) authority”

Clockwise from upper left: Pre-modern culture of Building (in sacred order) / Modernism / Hyper-Modernism

Modern Construction

Traditional Construction

Le Corbusier's "Five Points of the New Architecture:"

- 1) "Pilotis" as structure
- 2) **Roof Garden**
(requires flat roof)
- 3) **Free Plan** (interior walls can go anywhere)
- 4) **Free Façade** (exterior windows can go anywhere)
- 5) "Ribbon Windows" (horizontal)

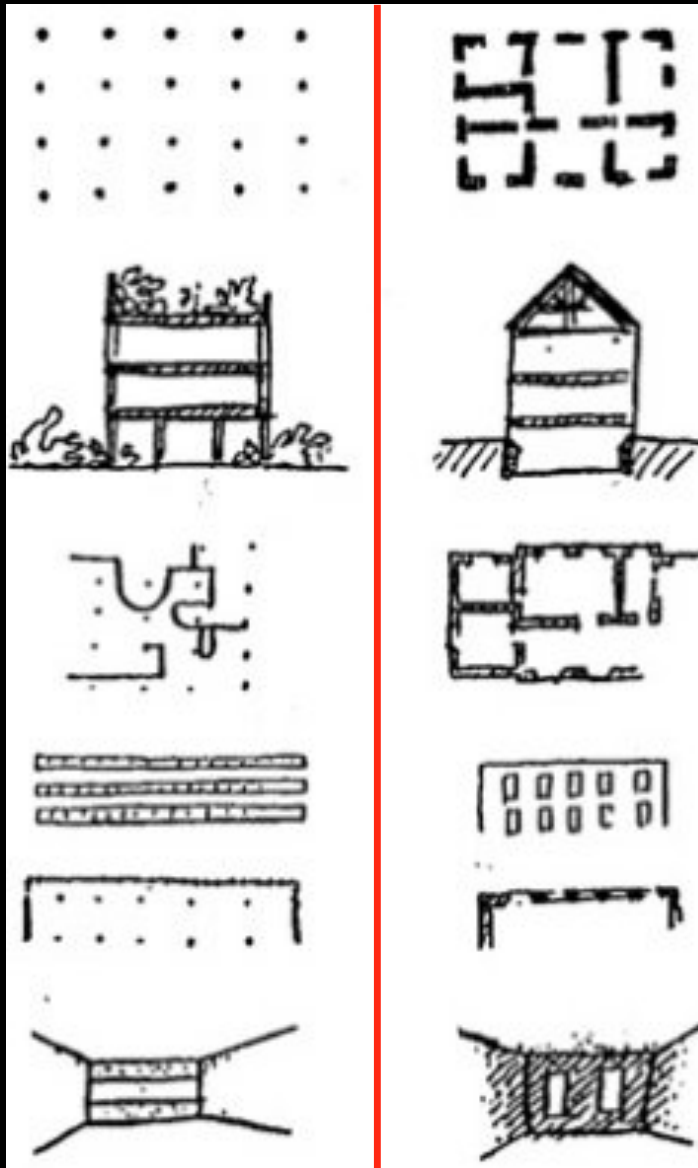



Bess' s Second Law of (modern) Architecture and Urbanism:
“Bureaucratic Culture (maximum public predictability) + Individual Autonomy
(maximum personal freedom) = An Incoherent Public Realm”



Junkspace

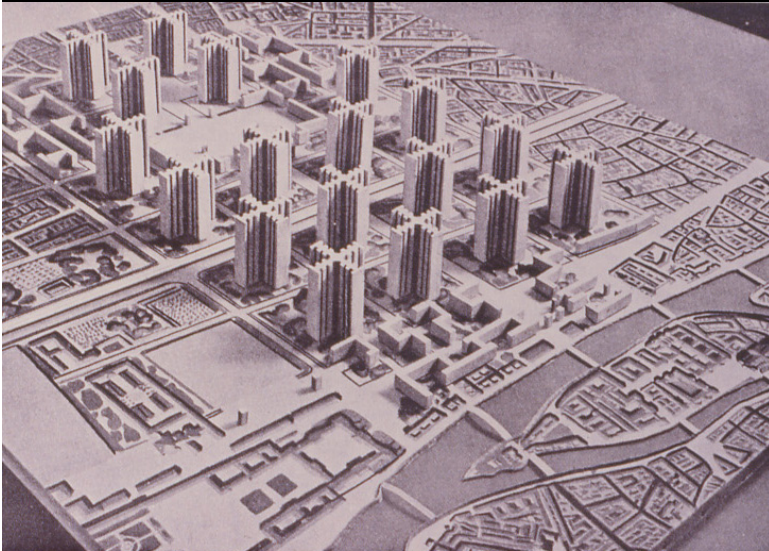

Left: The iconic modernist urbanism of Le Corbusier's *Plan Voisin* for Paris

Right: Collage of iconic hyper-modern buildings as icon of the hyper-modern Global City
(advertisement, courtesy of *Financial Times*)

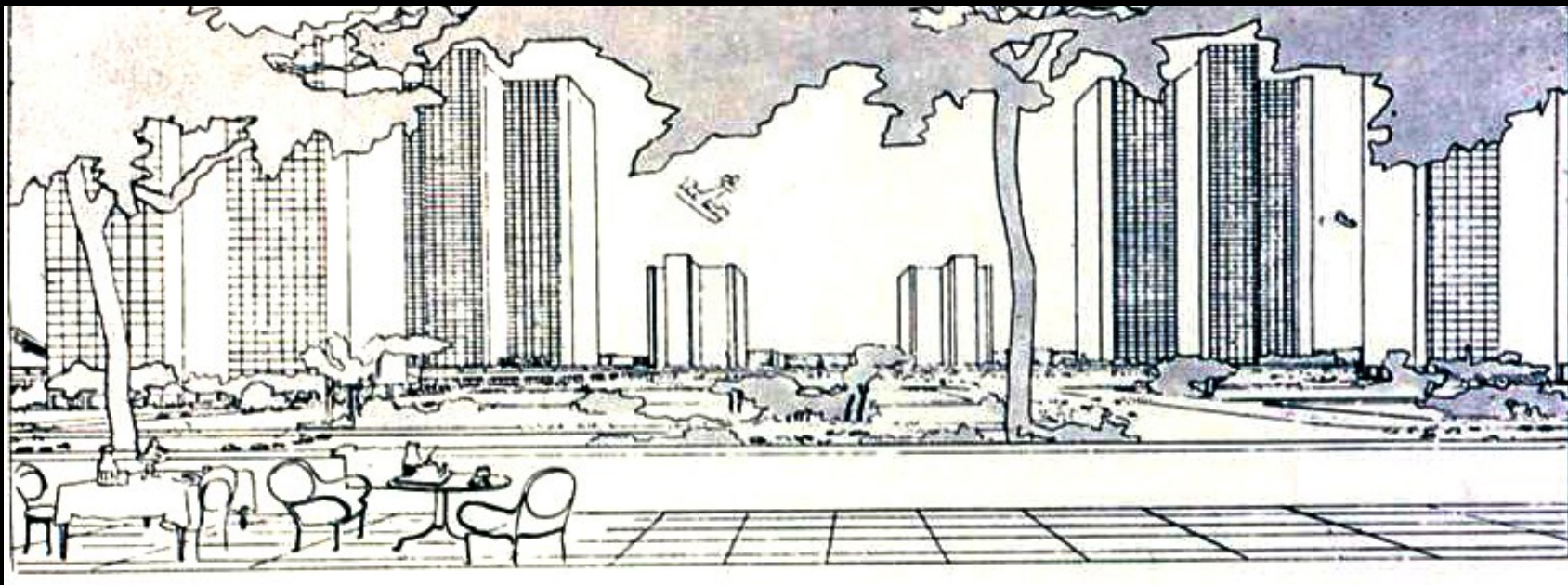

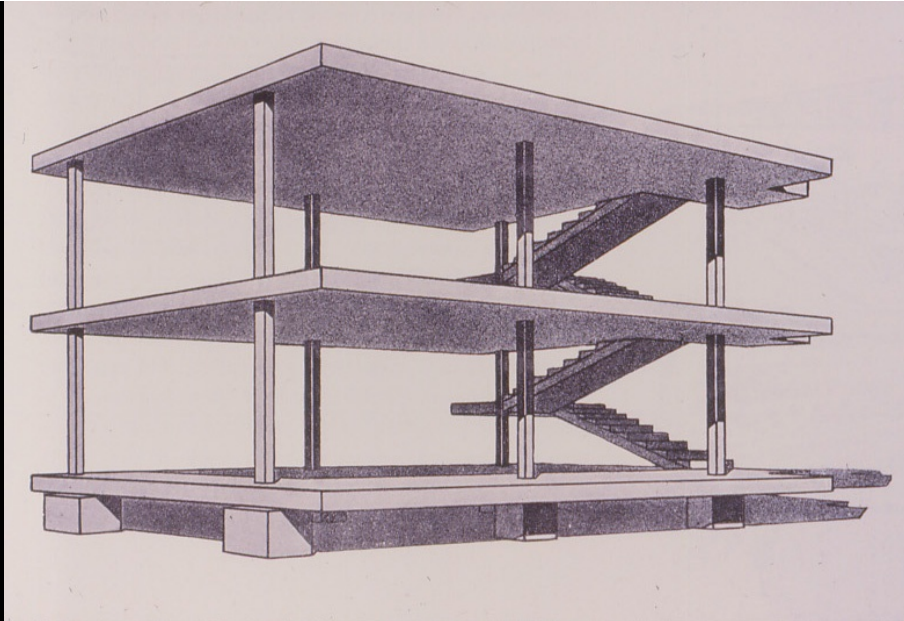

“Maison Domino” (the frame)



Villa Savoye (the house)

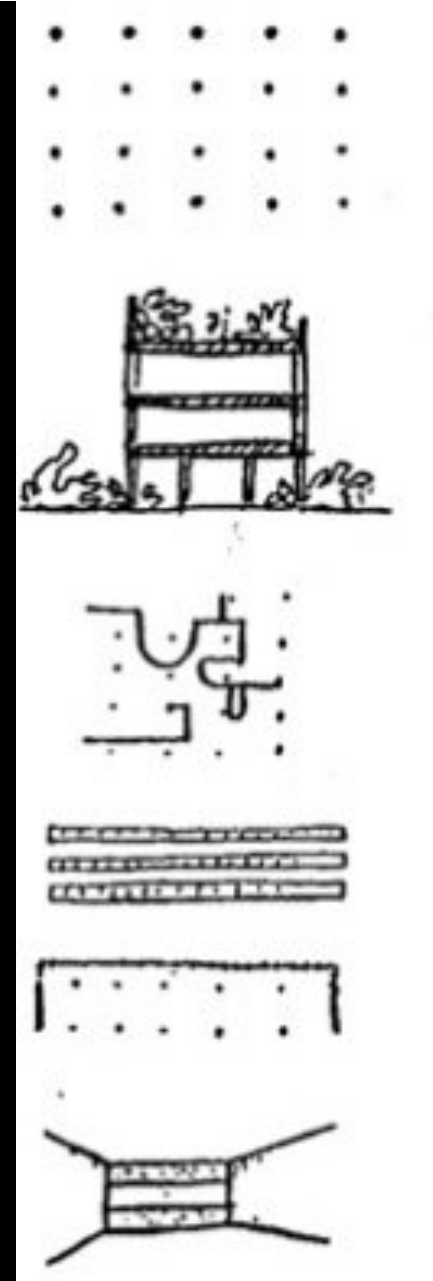

“5 Points” (the theory)

Genealogy of the House

30 A.D.



1030 A.D.



1830 A.D.



1930 A.D.

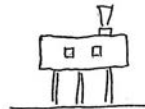

2030 A.D.



TEMPORARY REFUSAL of the ARCHETYPE



Leon Krier challenges Le Corbusier

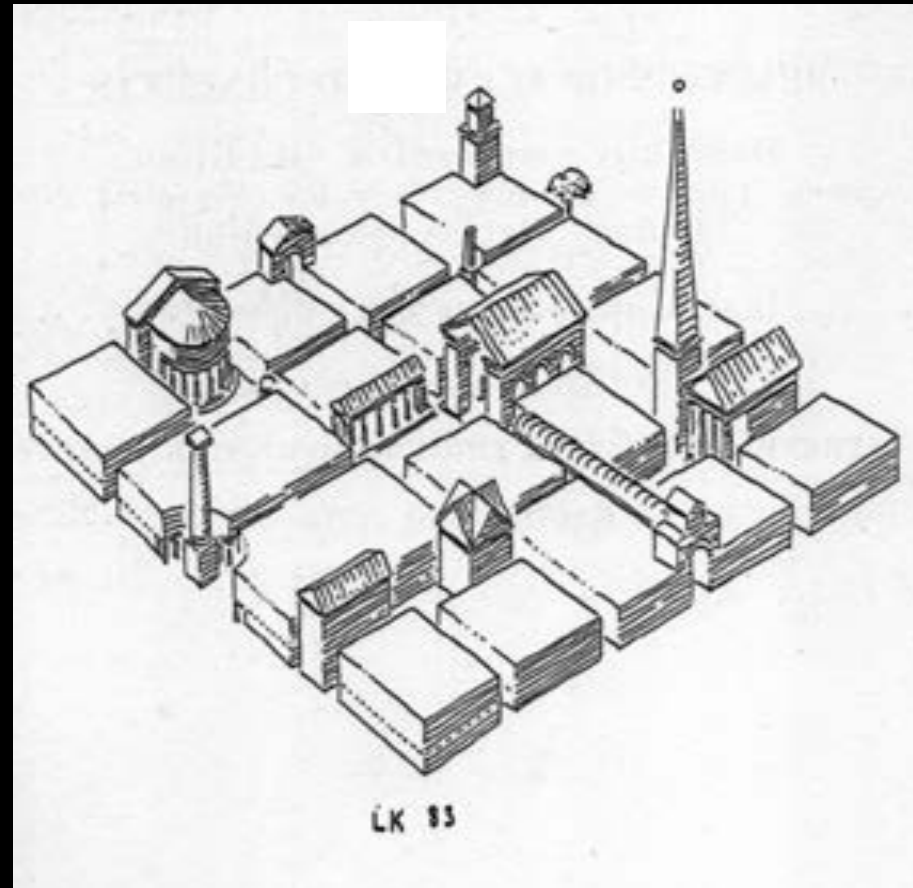
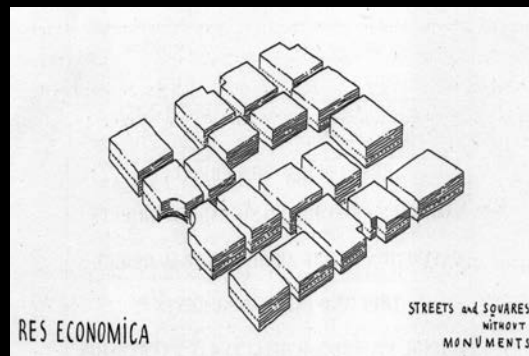
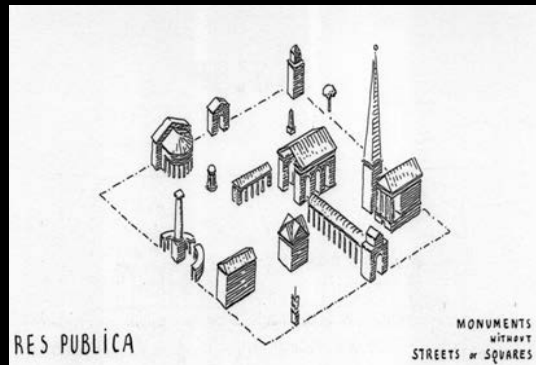

Characteristics of pre-modern towns and city neighborhoods (by Leon Krier):

1) Foreground and background buildings / 2) reciprocal relation between buildings and public spaces



Bruges (illustrates Bess's 3rd Law of Architecture and Urbanism)

The Market Square and Belfry



Church fronting a Bruges neighborhood public square



Bruges neighborhood churches terminating street vistas



The Beguinage / a medieval urban monastic quarter



The Beguinage / interior green with church and residences

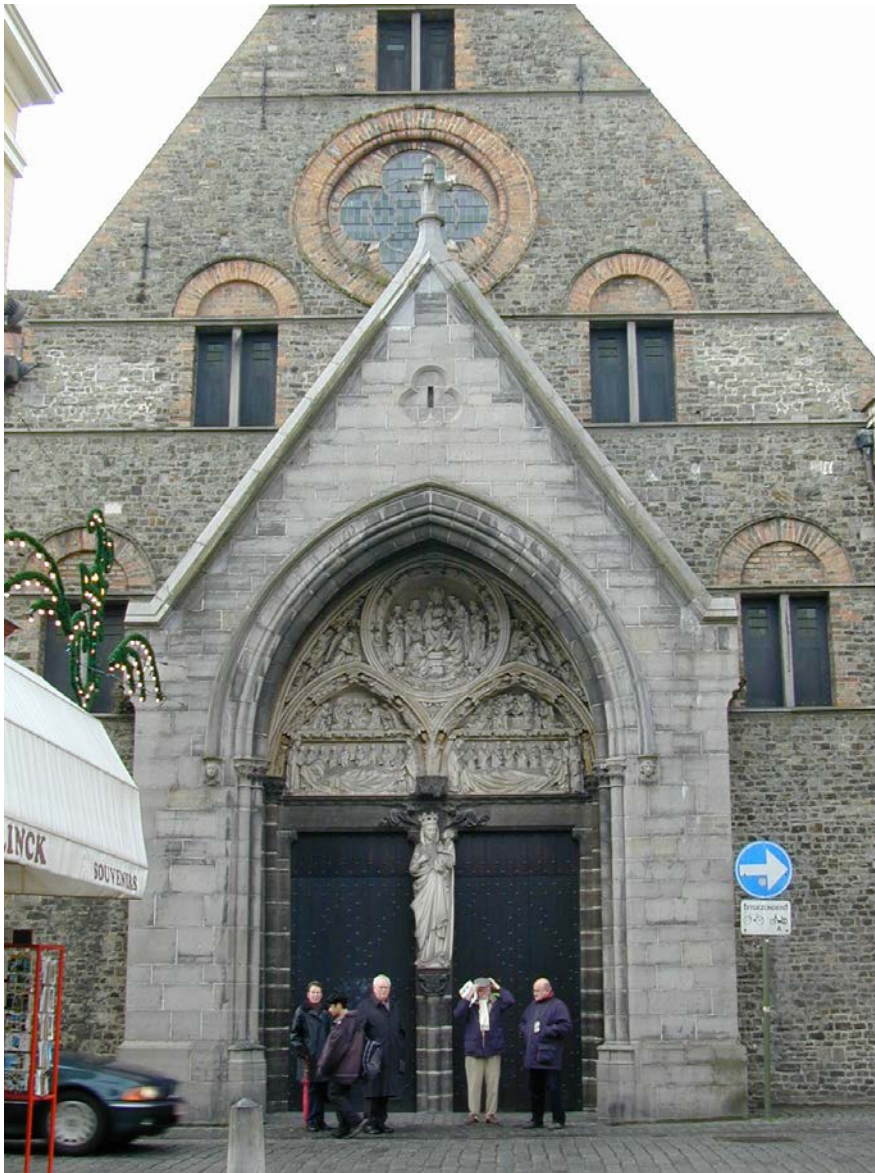

Old St. John's Hospital (12th century; now The Memling Museum)



One of dozens of Bruges' centuries-old alms houses still in use today (first of two slides)





Street-wise Madonna I (plain)



Street-wise Madonna II (fancy)

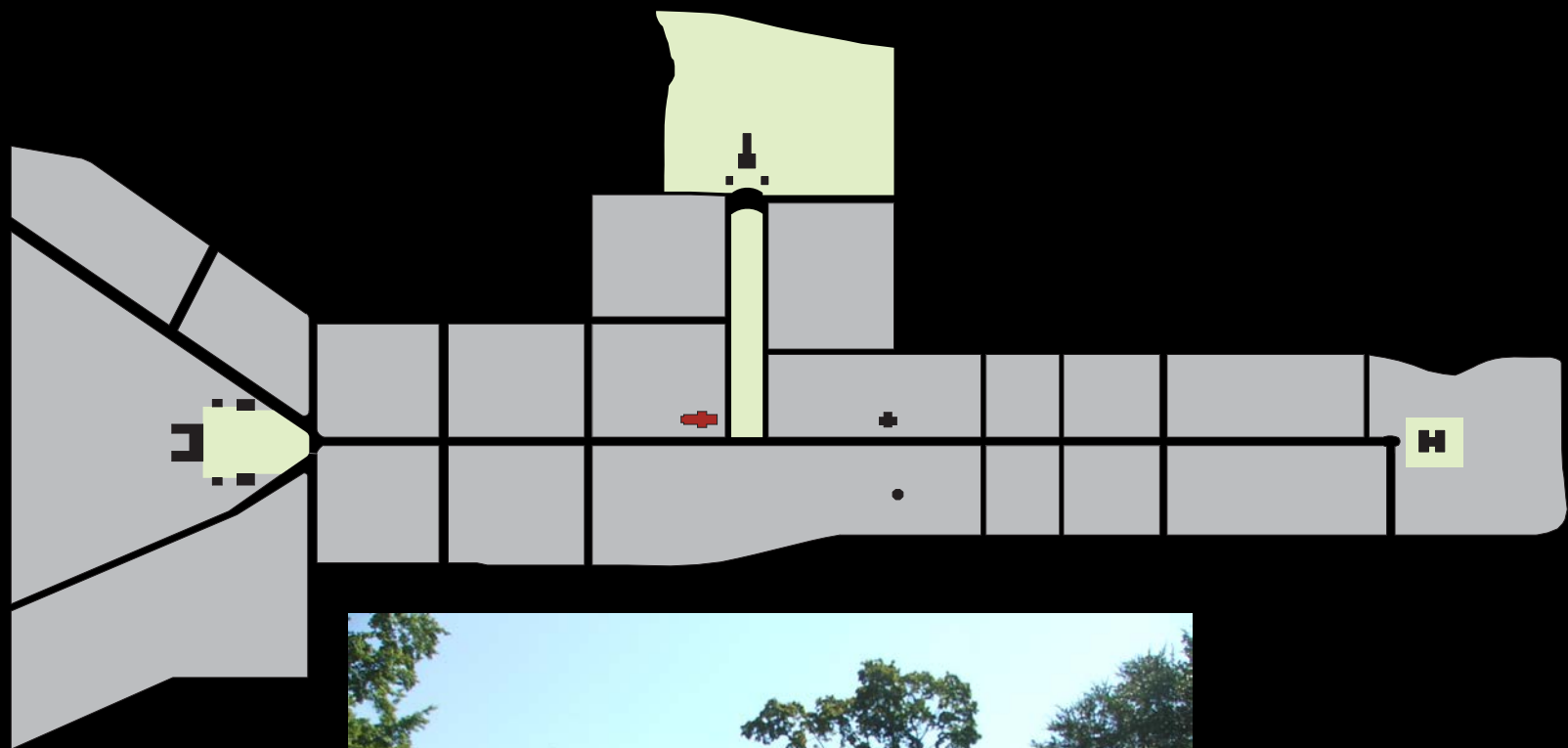

Williamsburg, VA – 1632 (a single “state church” located at main crossroads in a capital city)

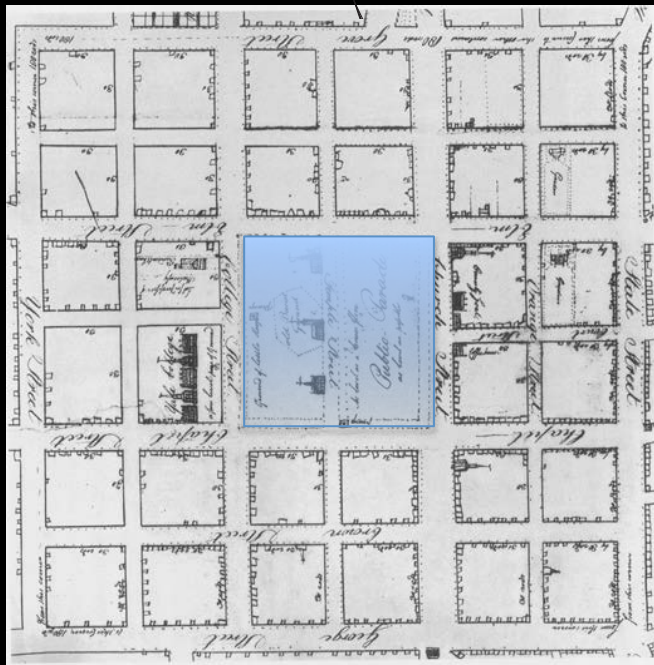
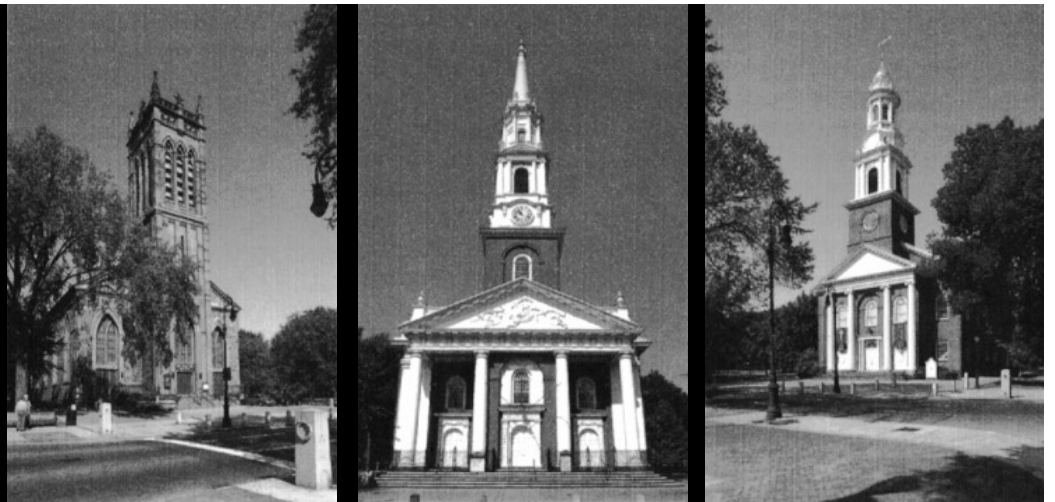
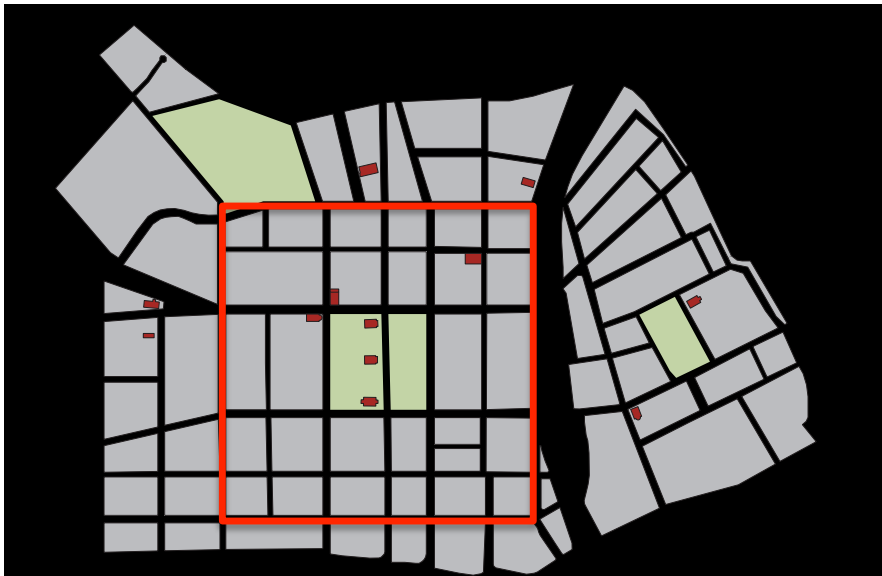

New Haven, CT - 1638 (city as microcosm);
central square, formal building disposition, plural churches in the one main square)

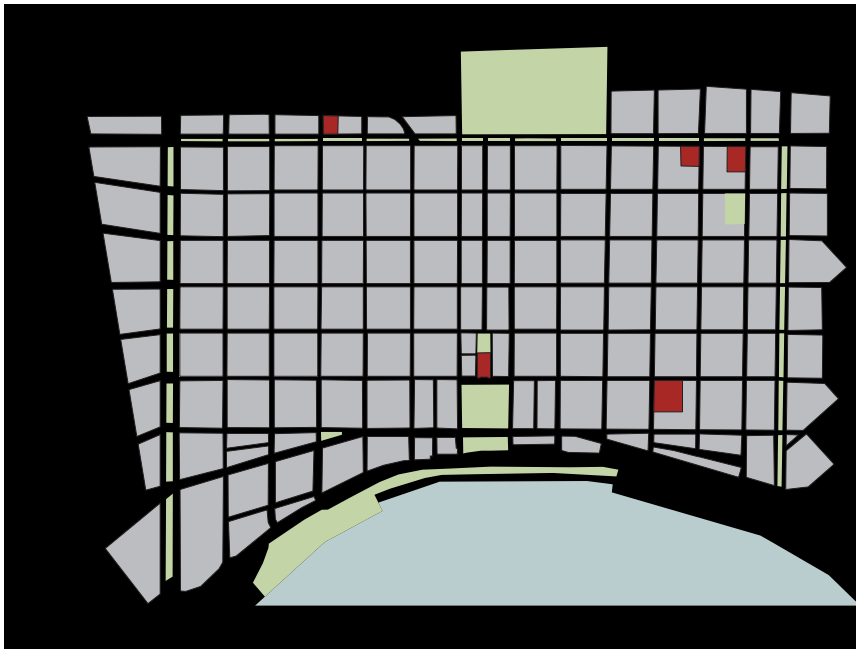

New Orleans, LA - 1718 (central square, single church, formal building disposition)

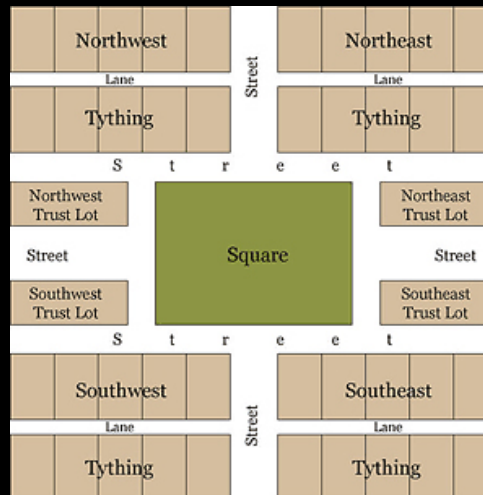
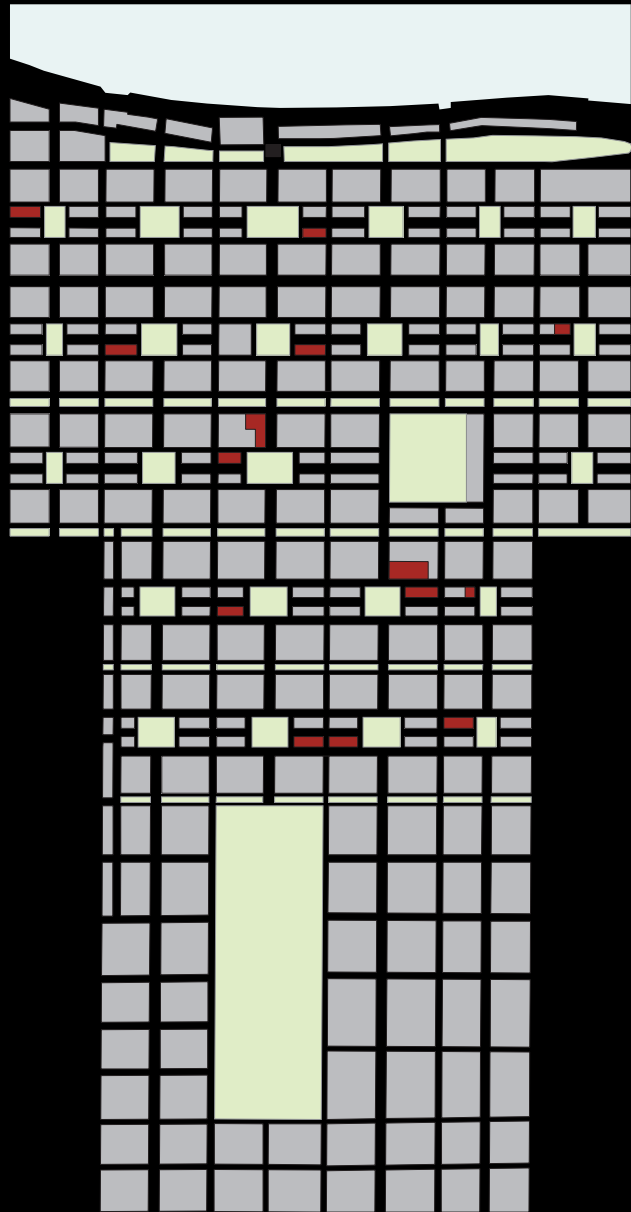

Savannah, GA - 1733 (poly-centric, plural, multiple churches on multiple squares, formally and informally disposed)

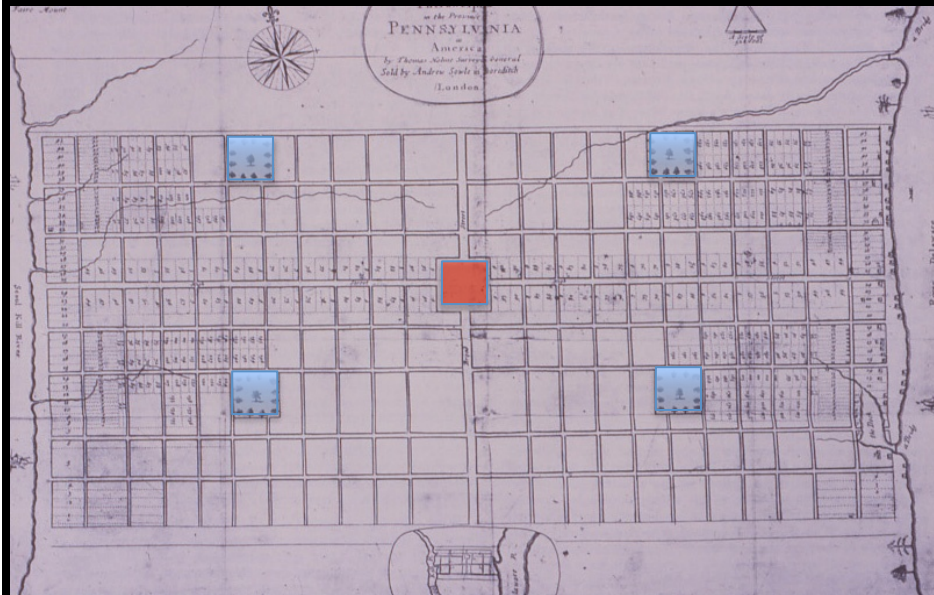

Philadelphia, PA - 1682 (polycentric, formal, cosmographic, with political center but no designated place for churches; n.b., founded by Quakers)

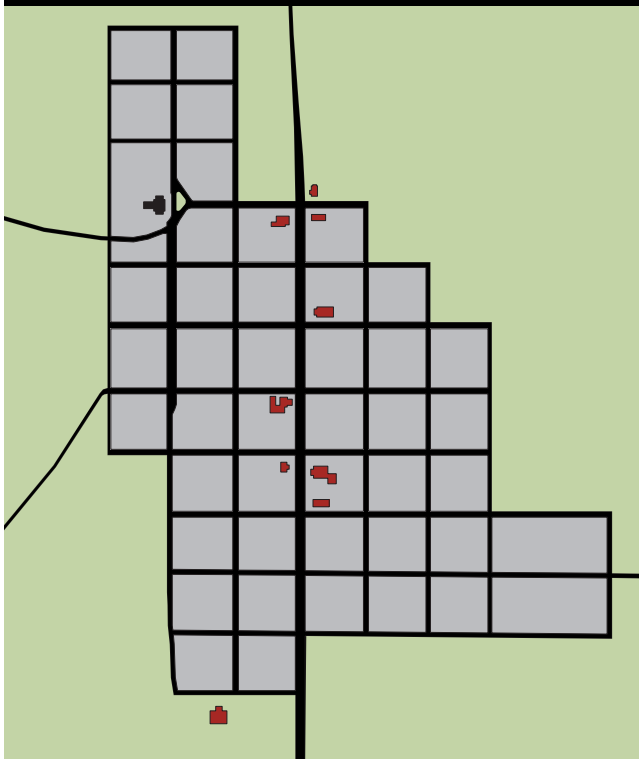

Port Gibson, MS – 1803
(Highway 61 churches: linear arrangement, multiple churches, informally disposed)

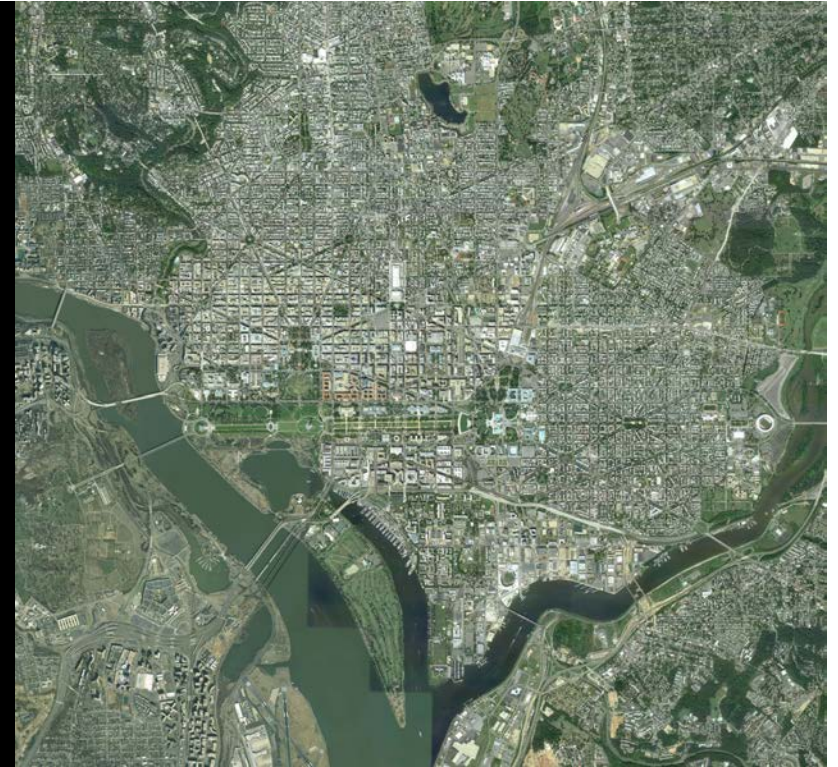

Washington, DC – 1791 (1901)

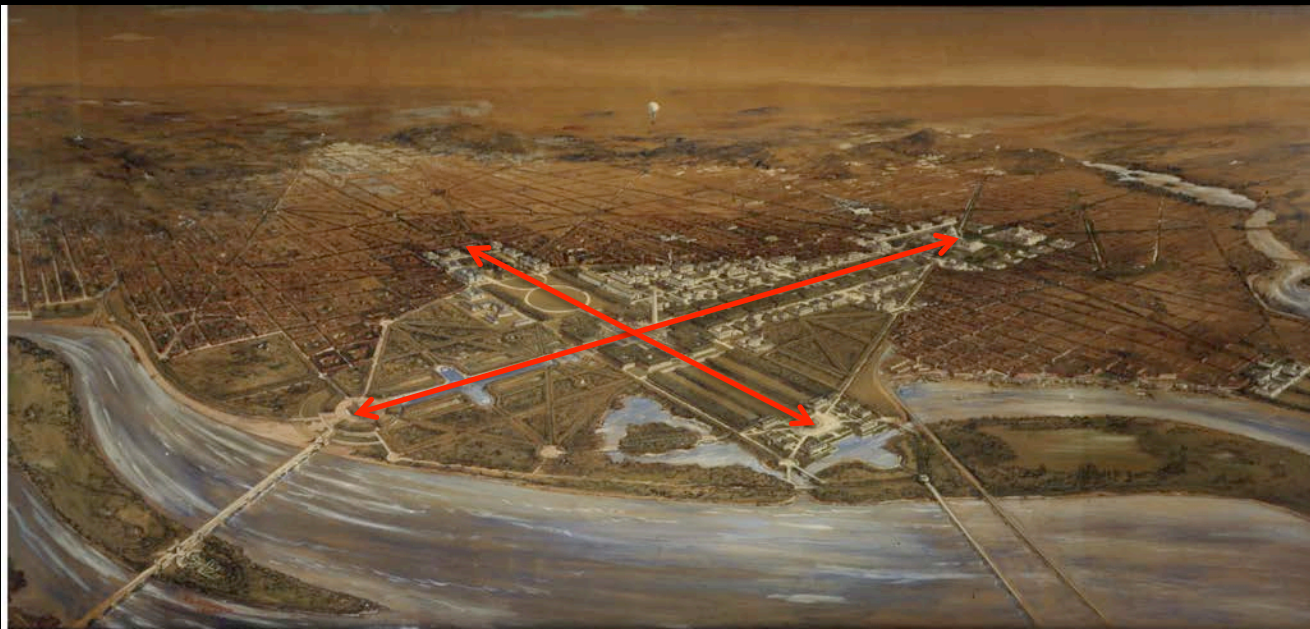
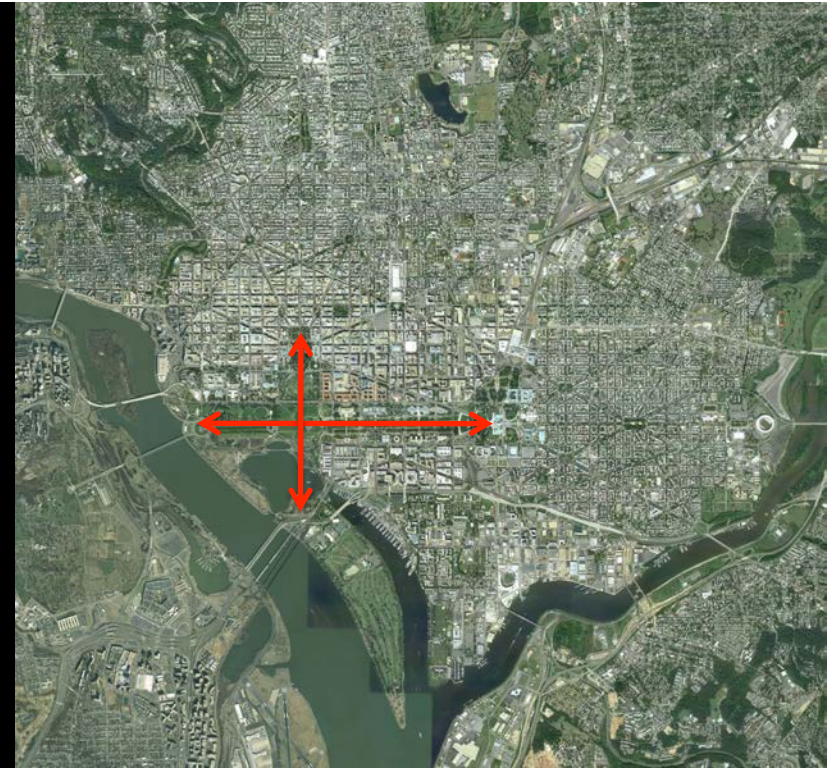

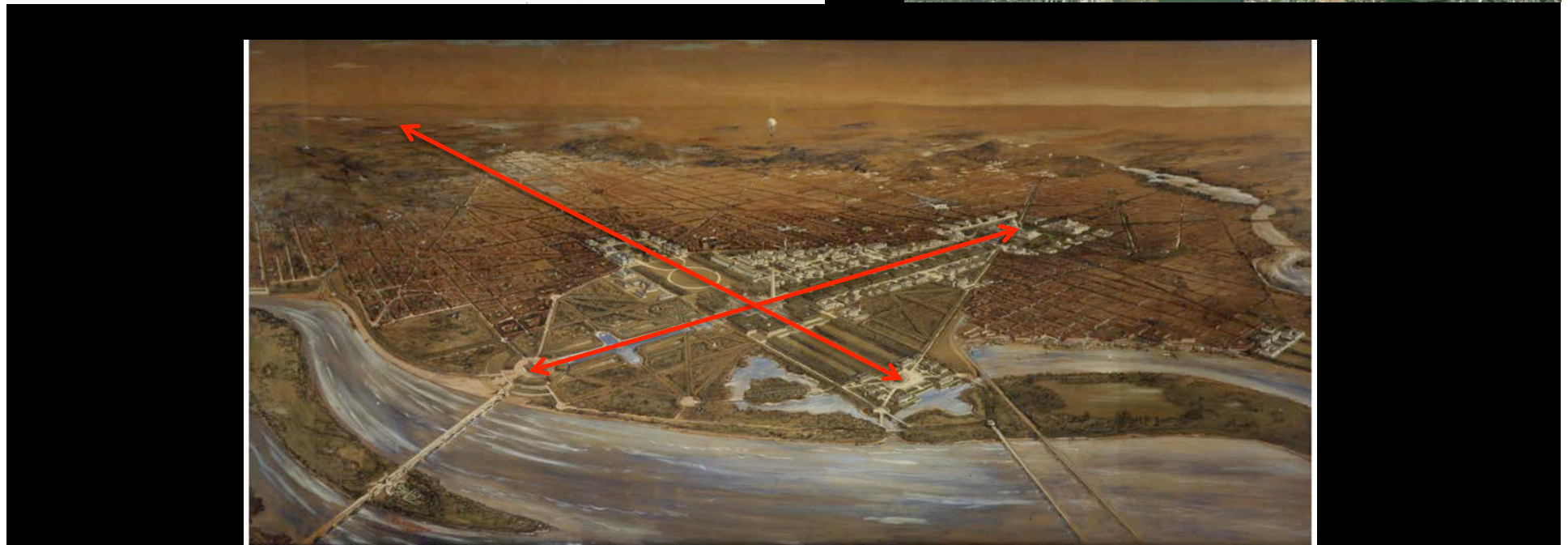
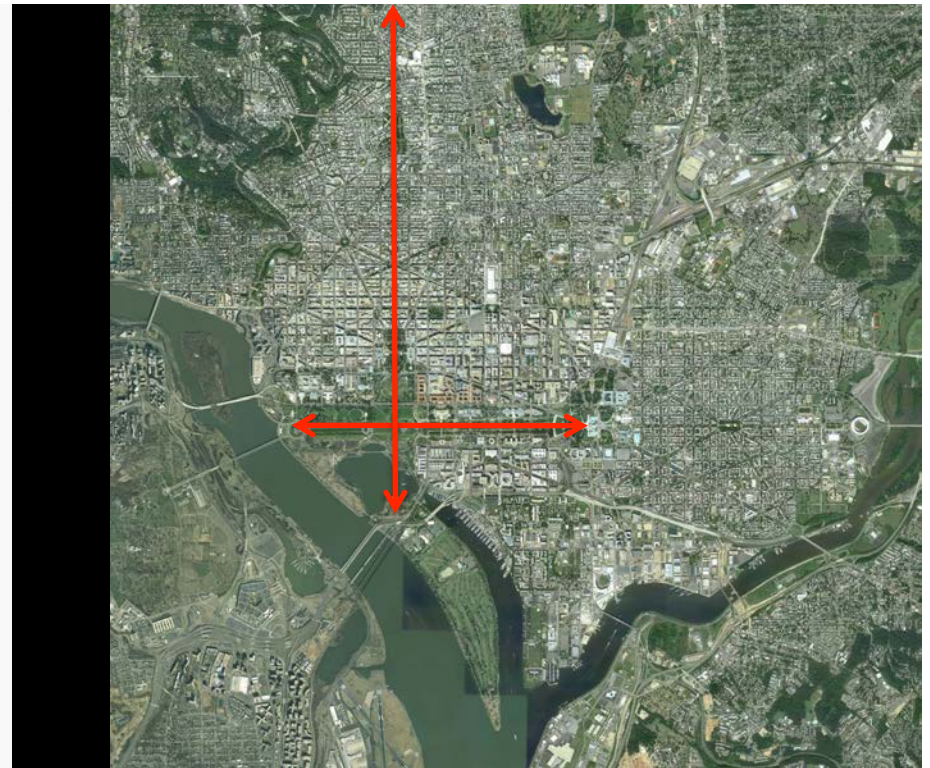
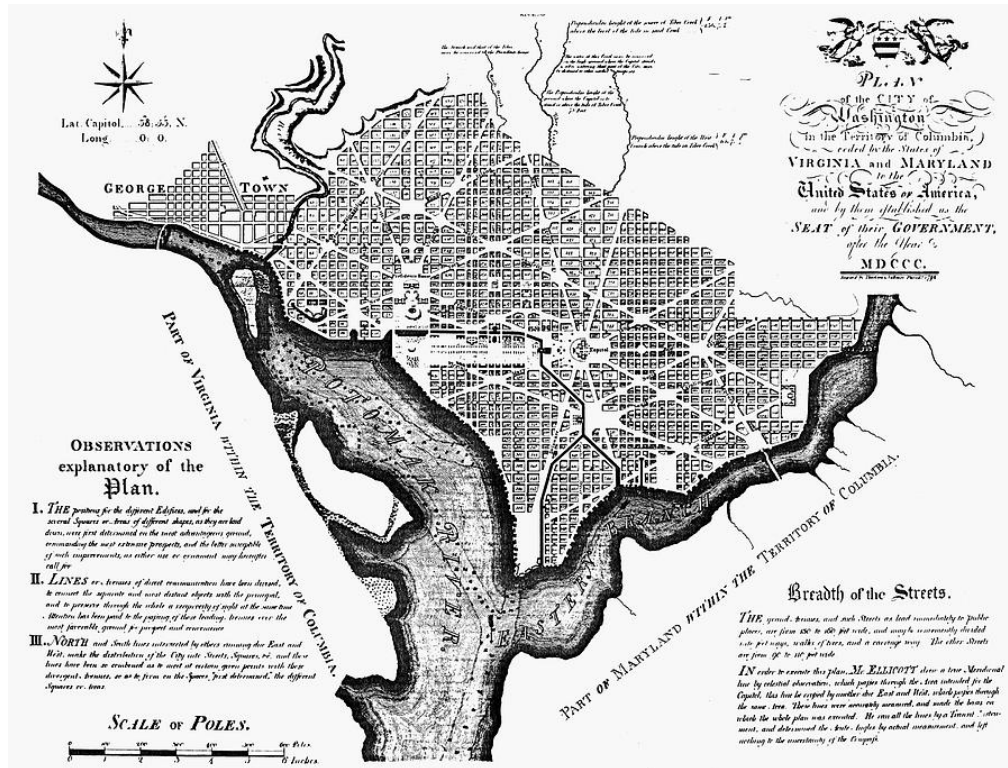

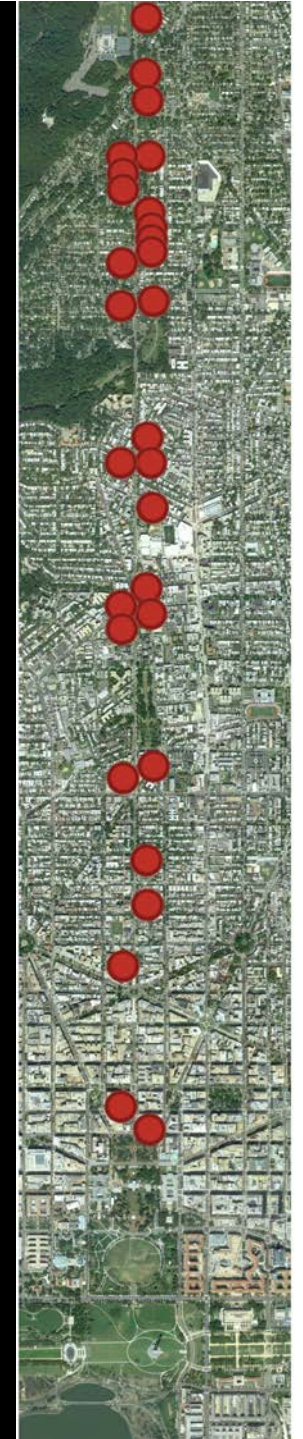
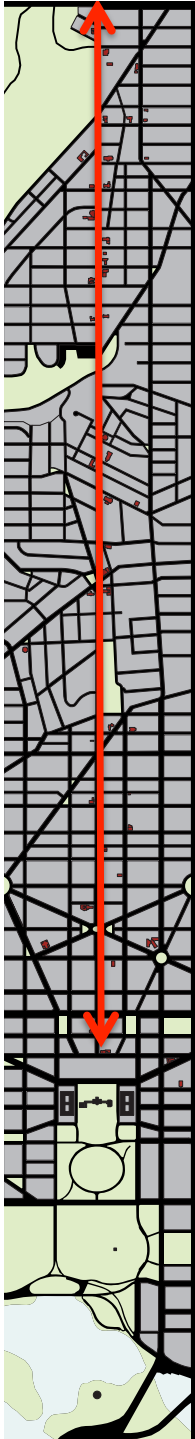

16th Street, Washington, DC
(linear arrangement, religiously plural informally arranged)



Suggestions and inspirations for roof

Glass roof would allow natural light to illuminate the space below

New spire made from crystal glass and stainless steel

Viewing platform

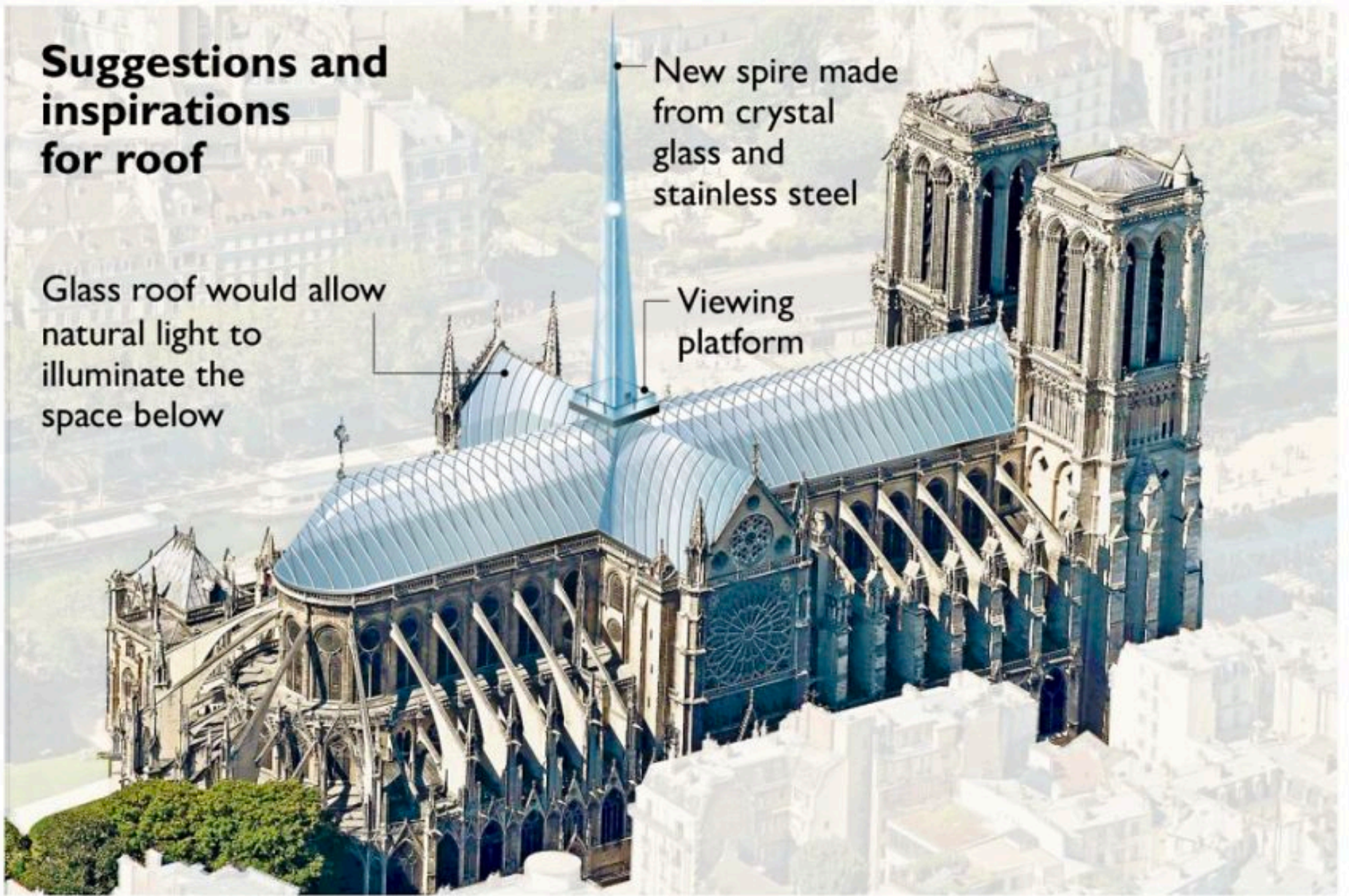







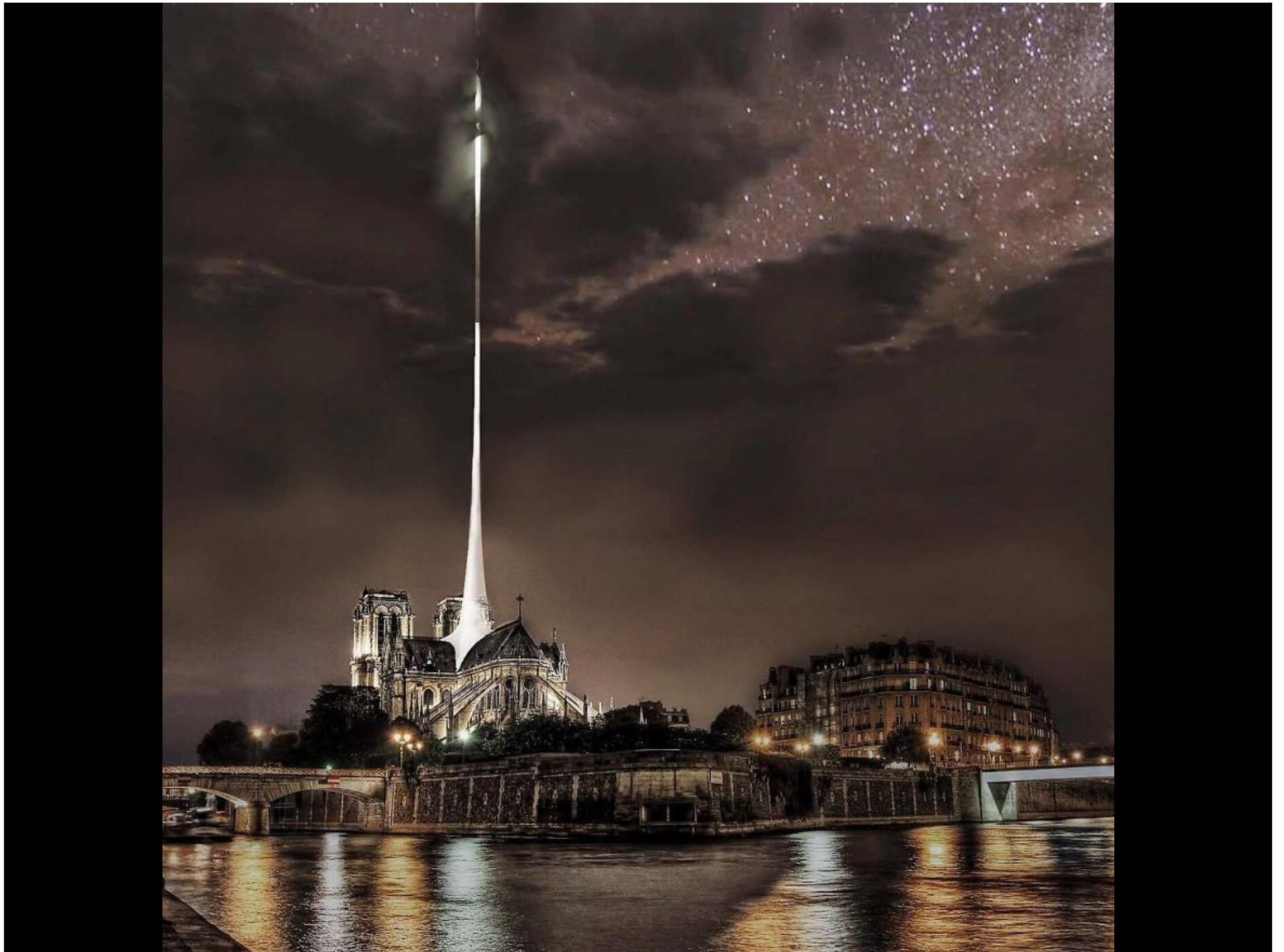





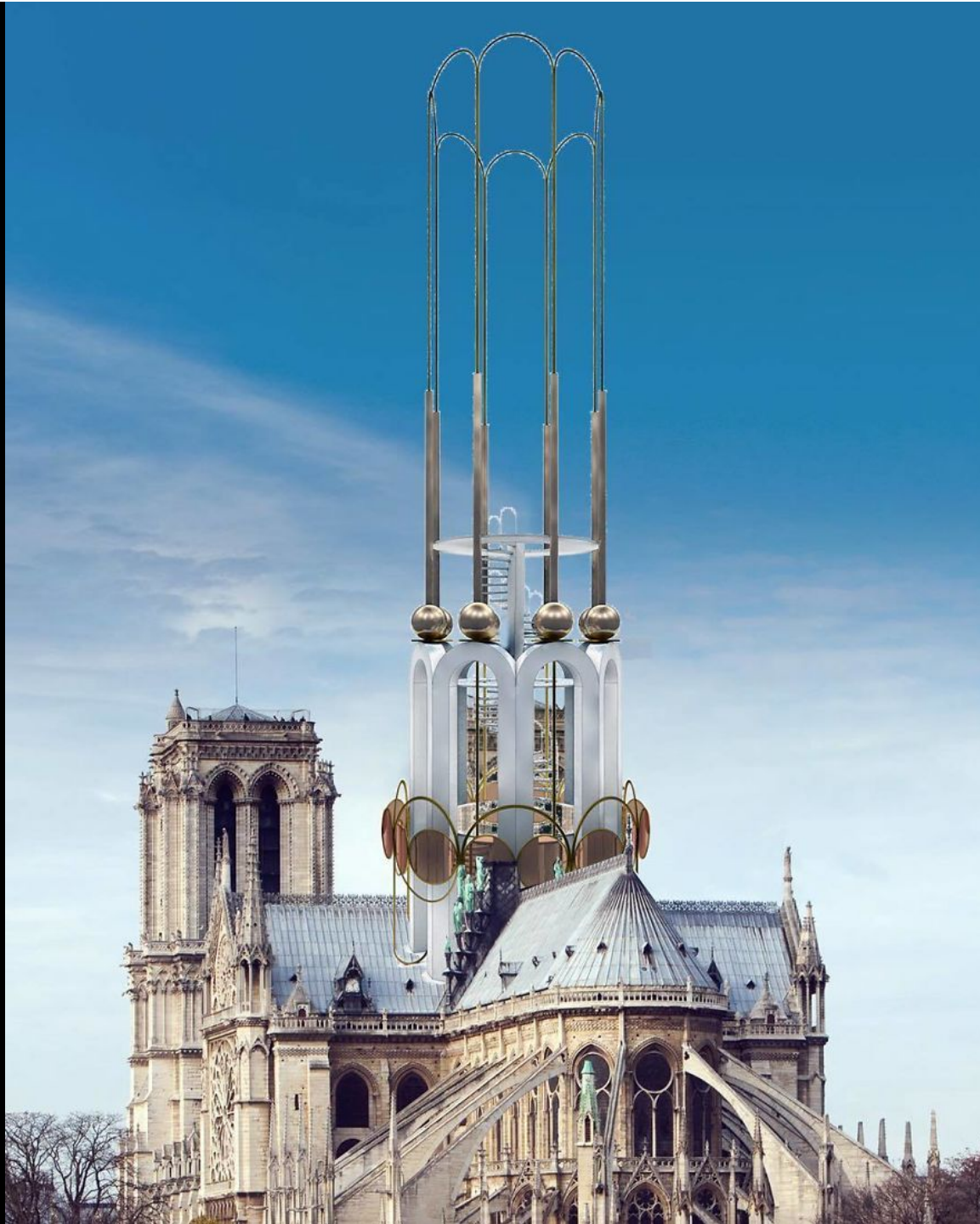



The American College of the Building Arts / Charleston, SC - MASONRY



The American College of the Building Arts / Charleston, SC - TIMBER FRAMING

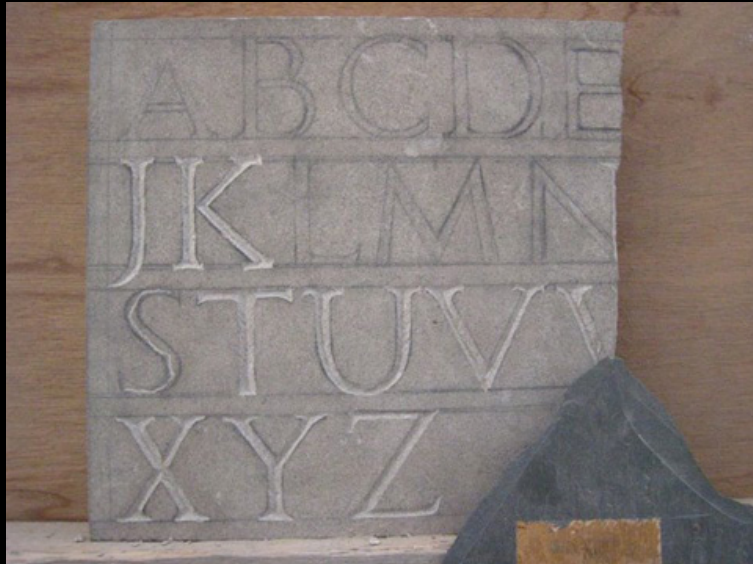

The American College of the Building Arts / Charleston, SC - STONE CARVING

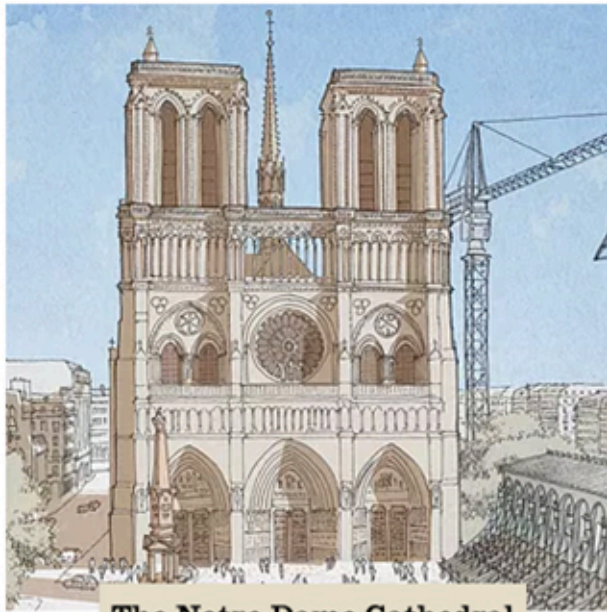

The Notre Dame Cathedral

The Heart

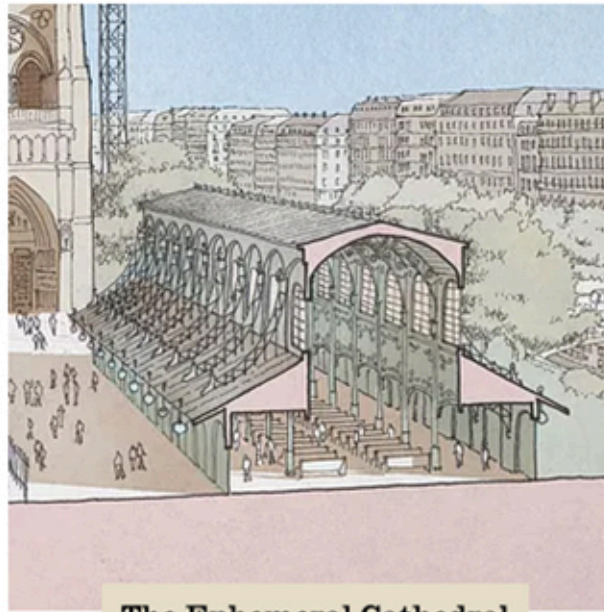

The Ephemeral Cathedral

The Mind

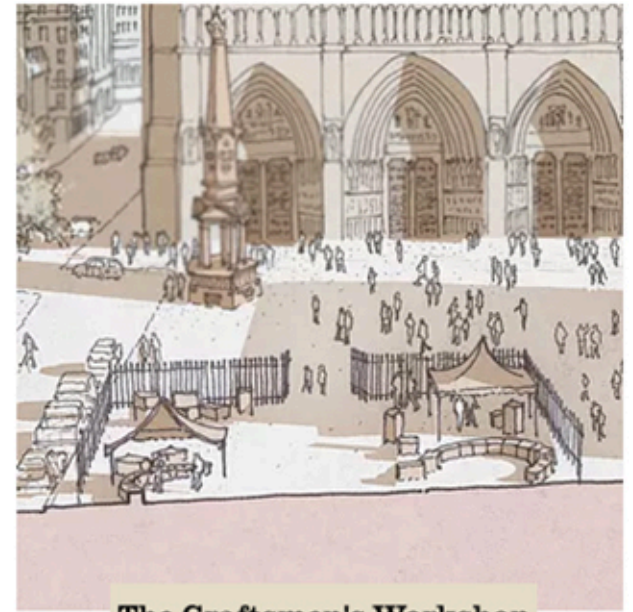

The Craftsmen's Workshop

The Hand

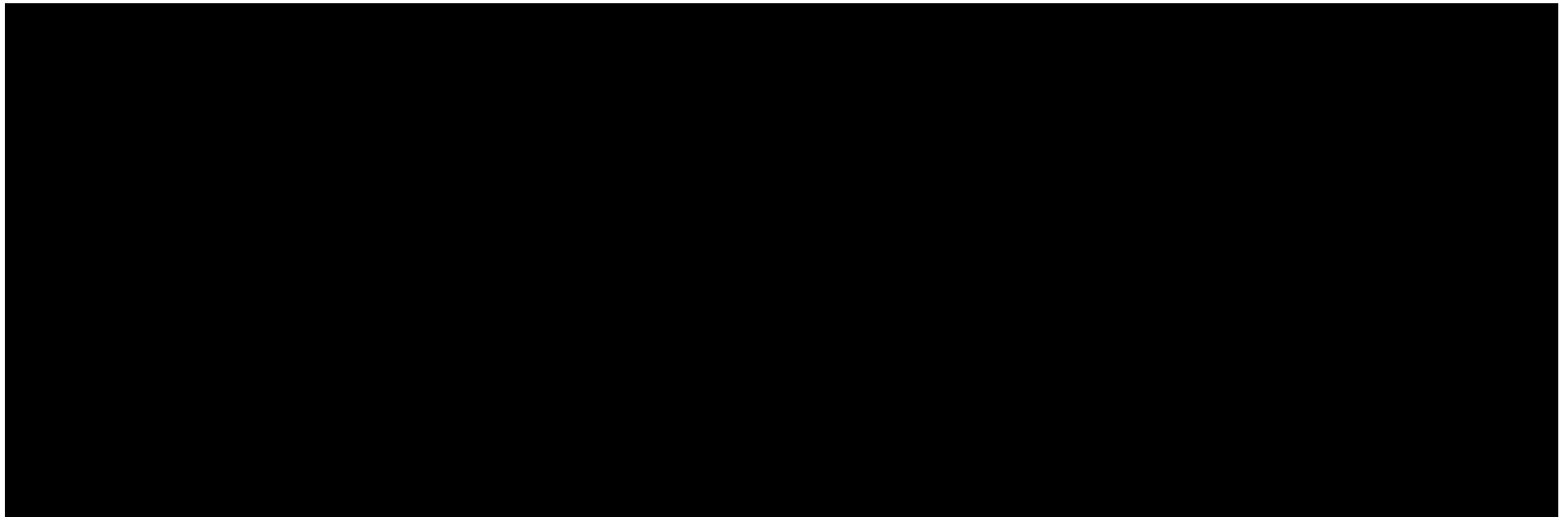

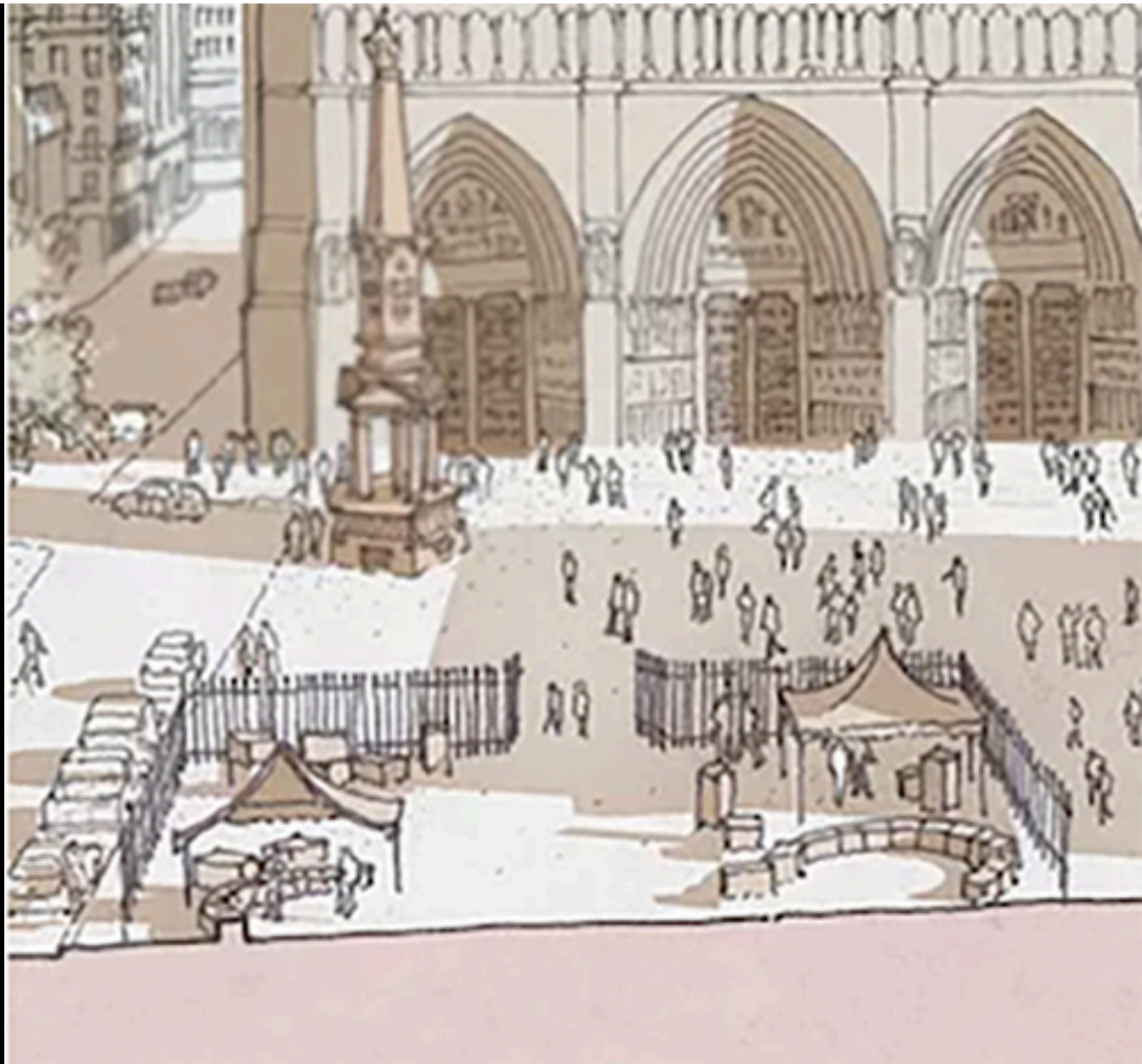

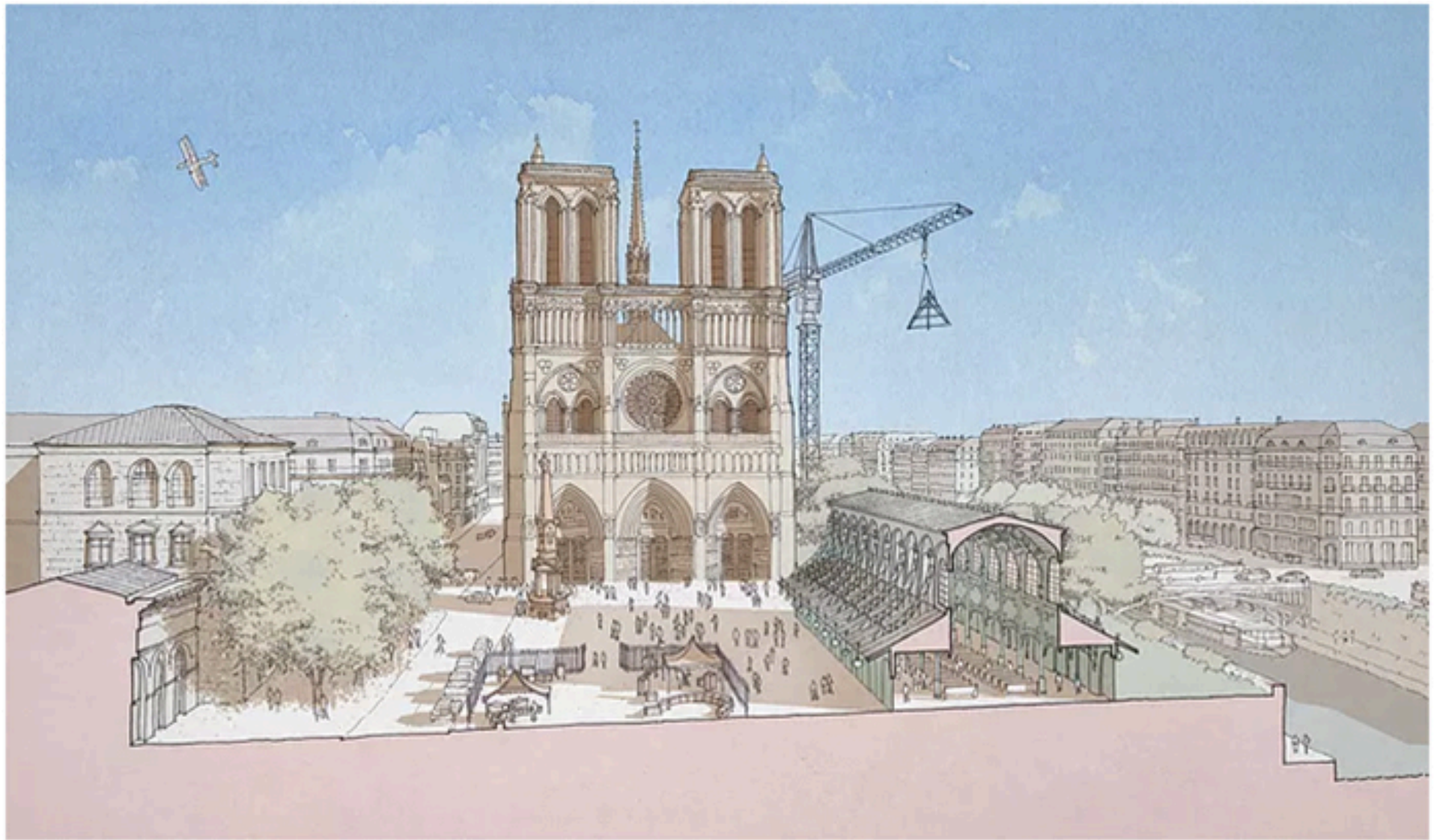

THE BURNING OF NOTRE DAME



A SYMPOSIUM ON SACRED ARCHITECTURE
& THE THEOLOGY OF BEAUTY

